

h y d r a u l i c s

MOTORES DE PALETAS MD4C

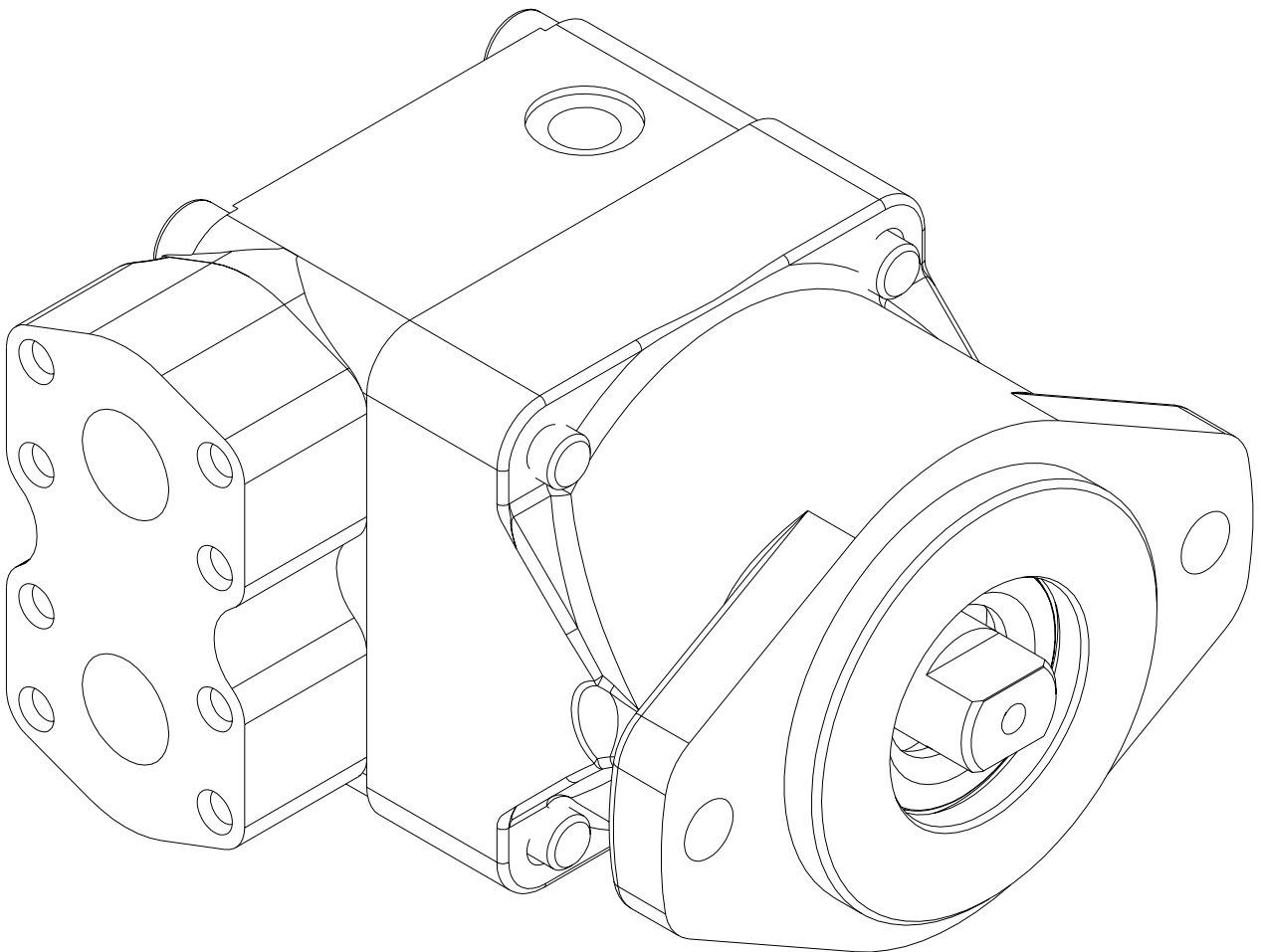

MD4C

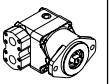

CODIGO DE PEDIDO

Modelo No.

MD4C - 075 - 1 - N - 00 - C 1 02 ..

Series de drenaje externo

Cudal nominal (par)

024	(0,39 Nm/bar)
027	(0,45 Nm/bar)
031	(0,55 Nm/bar)
043	(0,74 Nm/bar)
055	(0,93 Nm/bar)
067	(1,13 Nm/bar)
075	(1,27 Nm/bar)
100	(1,56 Nm/bar)

Tipo de Eje

- 1 = Enchavetado (SAE B)
- 2 = Enchavetado (no SAE)
- 3 = Estriado (SAE B)
- 9 = Especial (no SAE)

Sentido de giro

N = Bi-direccional

Modificación

Modos de Conexión

- 01 = Roscado a 1 5/16" UNF
Drenaje 9/16"-18 UNF
- 02 = Brida de 4 tornillos SAE 3/8"-16 UNC
Drenaje 9/16"-18 UNF
- 03 = Roscado a 3/4" BSP
Drenaje 3/8" BSP
- 04 = Brida de 4 tornillos SAE 3/8-16 UNC
Drenaje 3/8" BSP
- M4 = Brida de 4 tornillos SAE M10x20
Drenaje 3/8" BSP

Tipo de juntas

- 1 = 1

Tipo de diseño

Modos de instalación

- 01 = Lateral (izda/dcha)
- 02 = Lateral (arriba/abajo)

FUGAS INTERNAS

Fugas internas (l/min)

Vista desde el final del eje:

Sentido agujas reloj A = entrada
B = salida

Sentido contrario agujas reloj A = salida
B = entrada

Modos de instalación

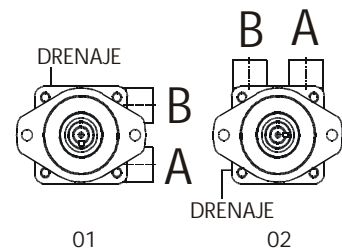

Presión (bar)

CARACTERÍSTICAS DE FUNCIONAMIENTO (24 cSt)

Modelo	Desplazamiento volumétrico (Vi)	Caudal de entrada a n = 2000 RPM		Par T a n = 2000 RPM	Potencia de Salida a n = 2000 RPM
		Teórico	a 175 bar Δp	a 175 bar Δp	a 175 bar Δp
	ml/rev	l/min	l/min	Nm	kW
MD4C - 024	24.4	49.0	63.0	60.5	12.7
MD4C - 027	28.2	56.0	70.0	70.0	14.7
MD4C - 031	34.5	69.0	83.0	86.8	18.0
MD4C - 043	45.5	93.0	107.0	120.0	25.1
MD4C - 055	58.8	118.0	132.0	149.0	31.2
MD4C - 067	71.1	142.0	156.0	170.0	35.6
MD4C - 075	80.1	160.0	174.0	198.0	41.5

MODOS DE CONEXIÓN

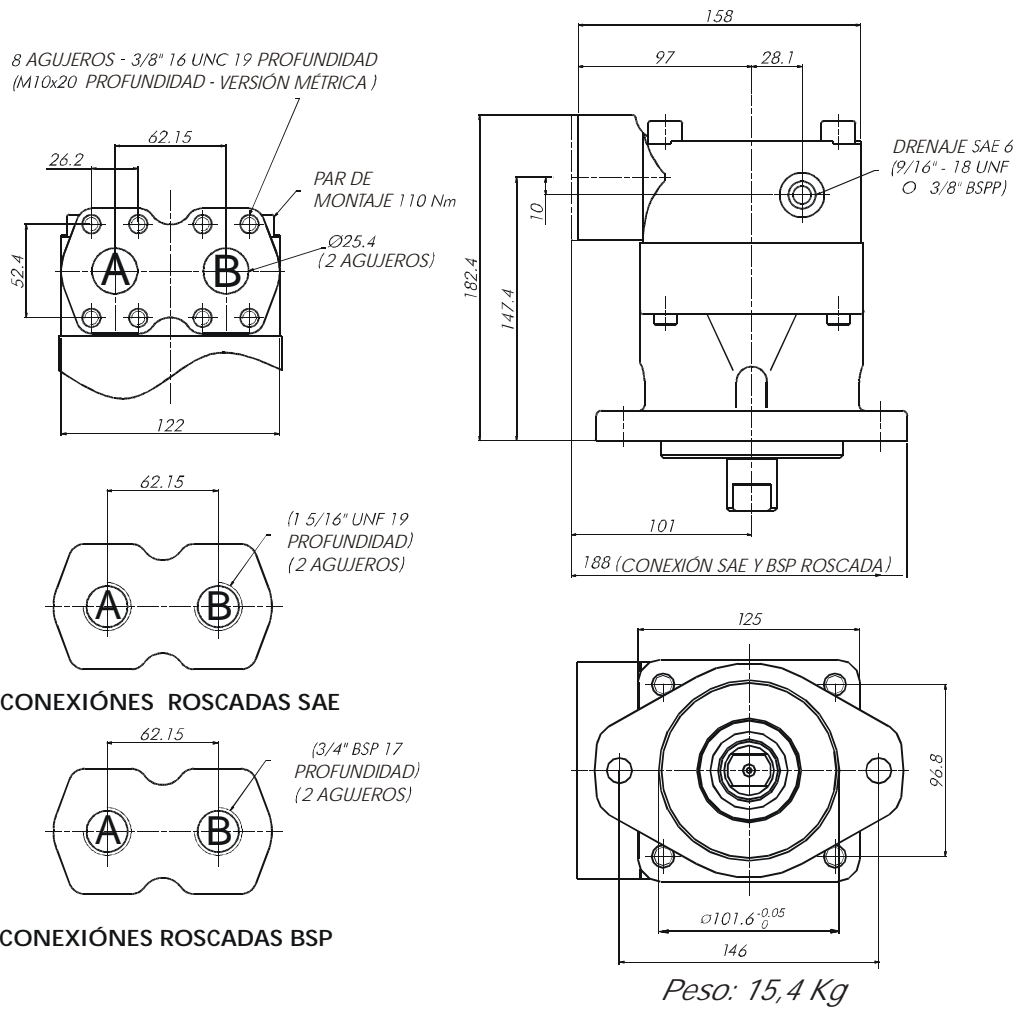

TIPO DE EJE

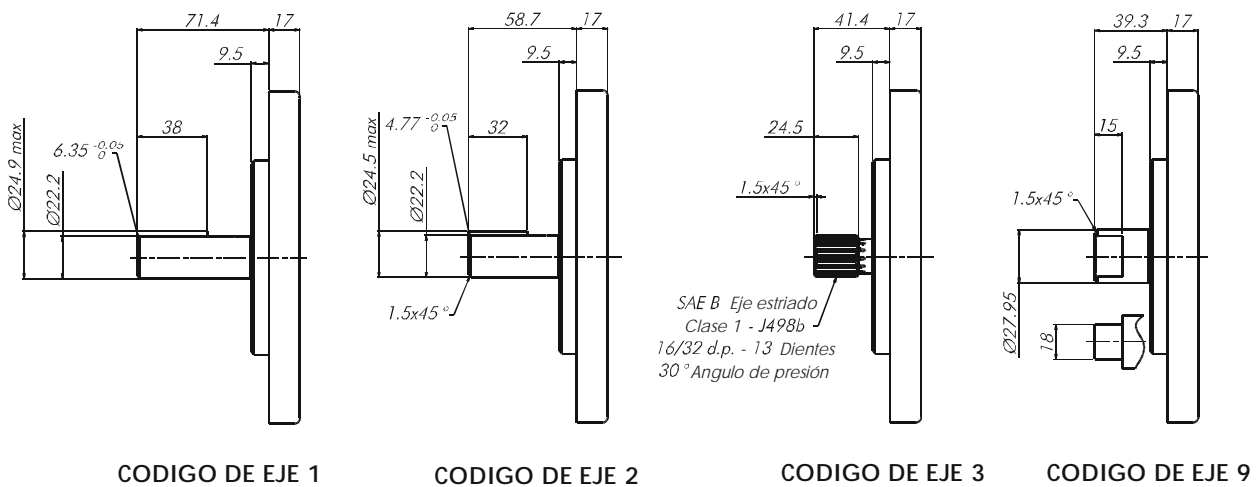

MD4C

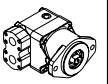

Para otros tipos de ejes, rogamos consulten

**MD4C
024**

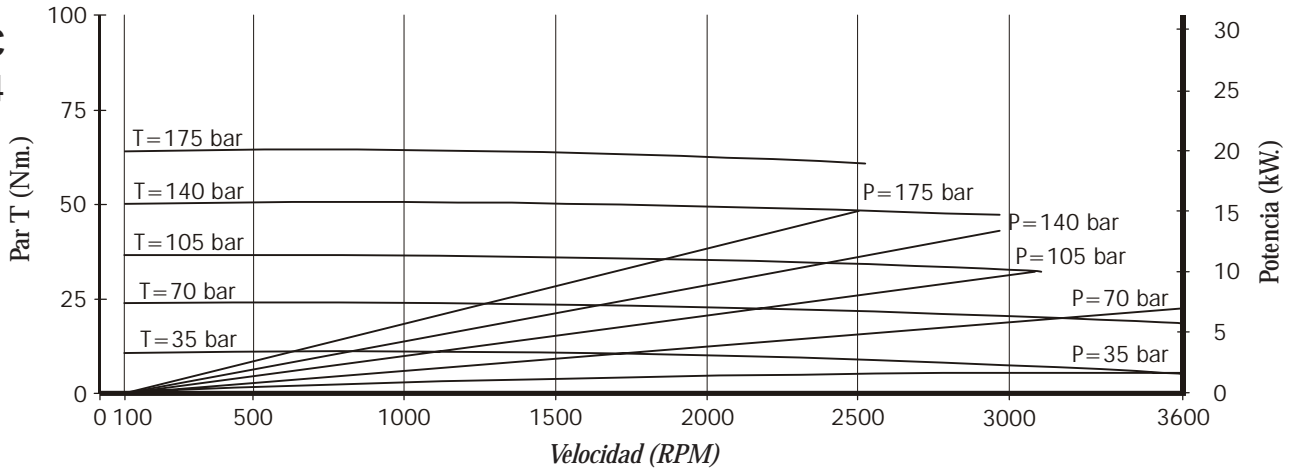

**MD4C
027**

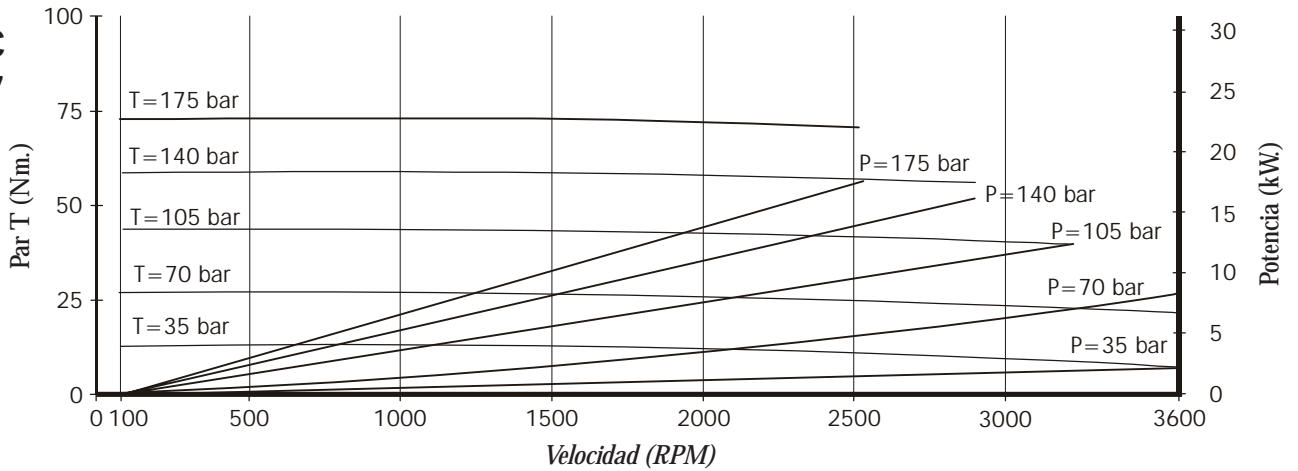

**MD4C
031**

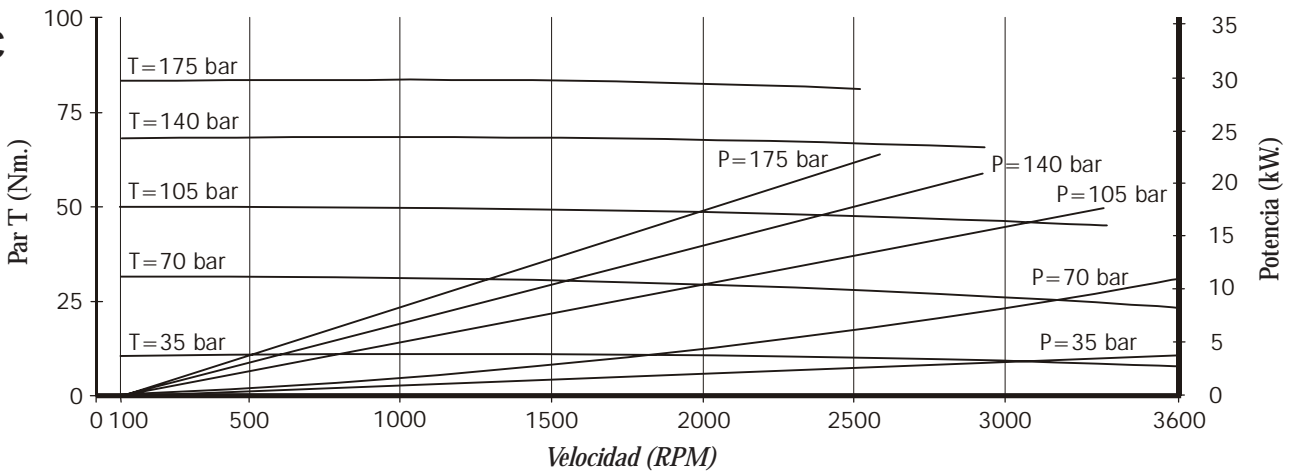

**MD4C
043**

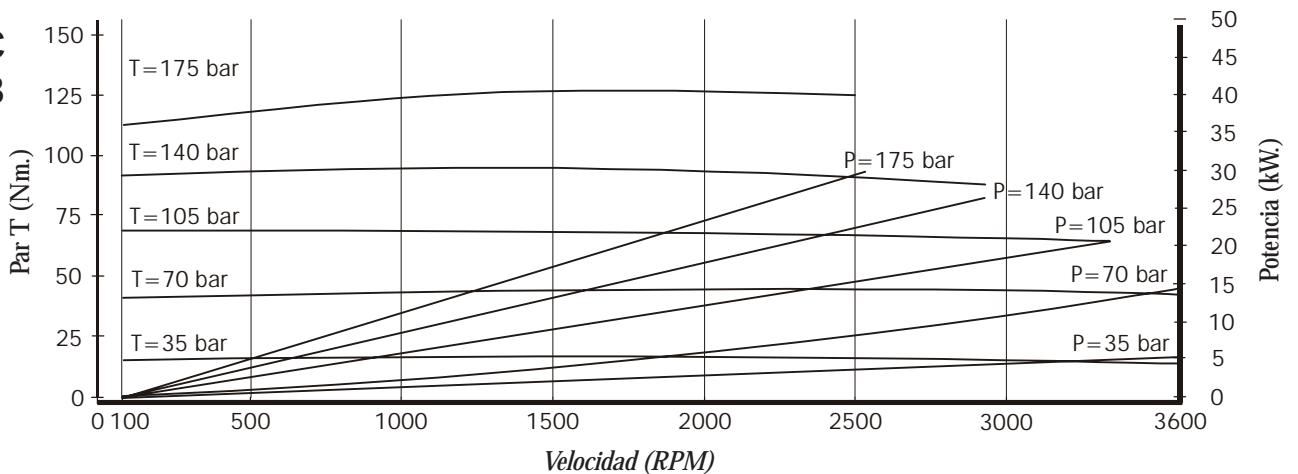

**MD4C
055**

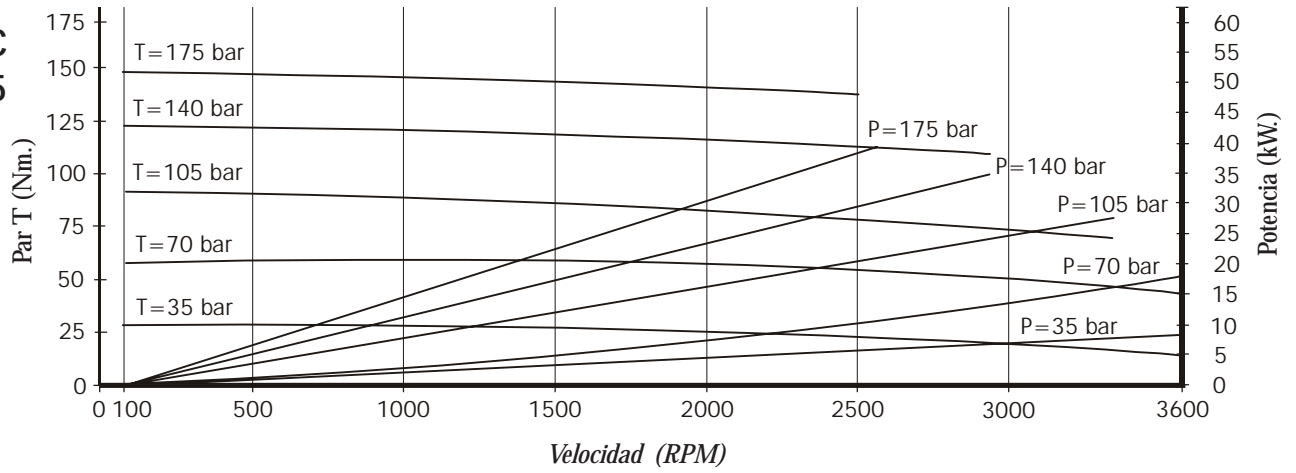

**MD4C
063**

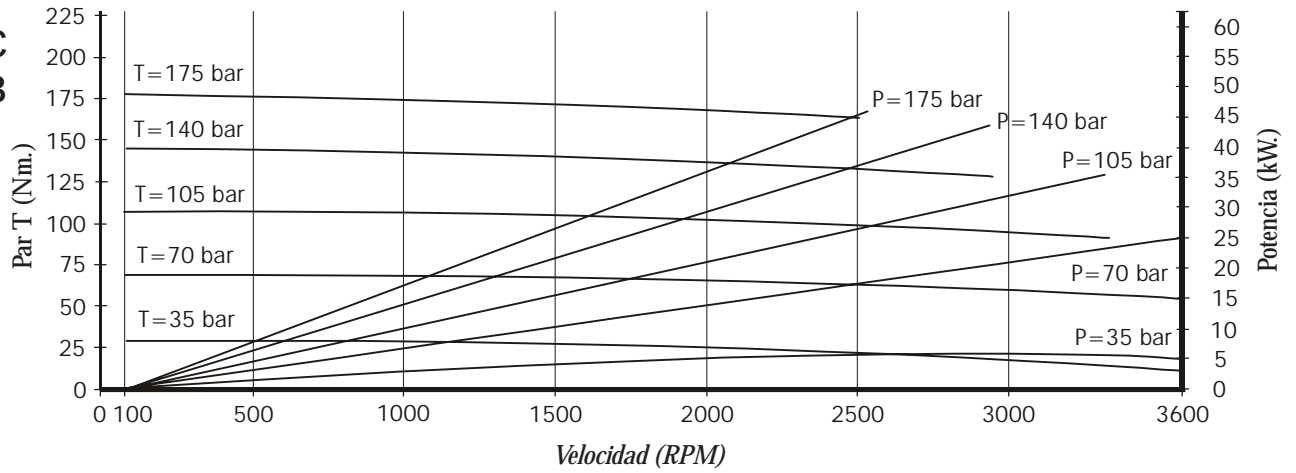

**MD4C
075**

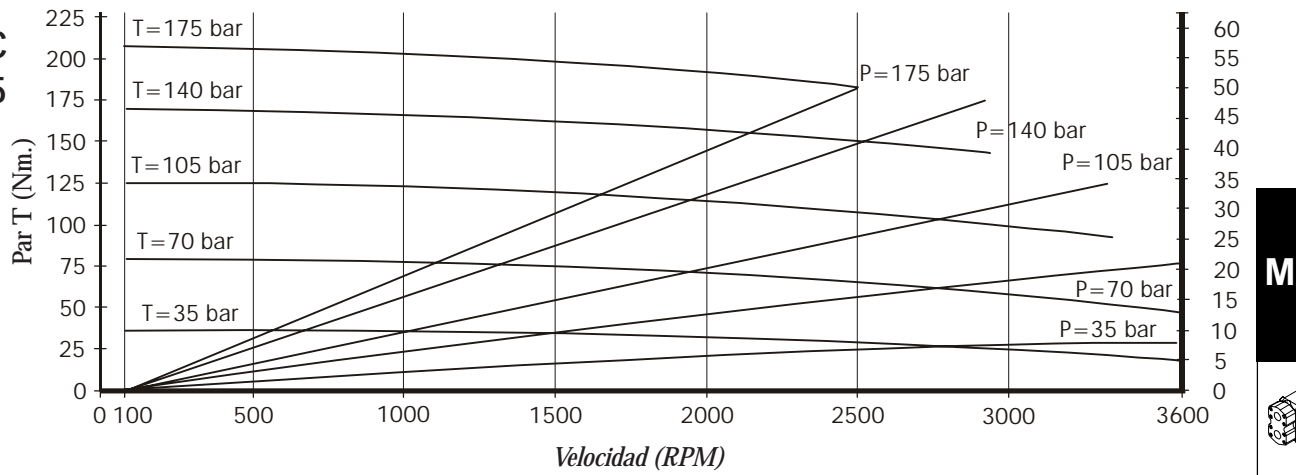

MD4C

